

Flymagic Interface

Patent and innovation of Flydigi with one interface achieving double functions:
Function 1: activate button mapping
Function 2: extend keyboard and mouse connection

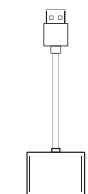

Flymagic Adapter

See keyboard-mouse mode connection instructions for usage

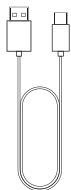

Charging cable

Can be used as charging cable of controller as well as power connection cable of Flymagic

Connection instruction for controller

STEP1: Download Flydigi Controller Assistant (For Android users, please download Flymagic version)

Scan QR Code to download and install Flydigi Controller Assistant

Or: Use browser to visit Flydigi official website: www.flydigi.com to download



STEP2: Activate Flymapping

Open USB debugging mode on the phone according to Flydigi Controller Assistant – Enable button mapping, and complete the following steps

Connect phone with controller, using data cable provided with the phone, as shown in the right figure

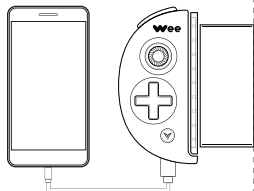

Turn the power switch to the right again, until the phone prompts USB debugging authorization, select "OK". After activation is successful, orange indicator will stay steadily on for 5 seconds before it goes out

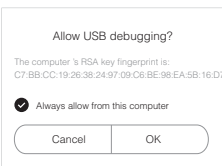

STEP3: Use Bluetooth to connect phone

Complete the following steps according to Flydigi Controller Assistant – controller connection instruction

1. Turn the power switch to the right, press and hold Logo button for 5 seconds Controller goes into pairing mode

(Status indicator will quickly flash blue)



2. Click phone Setting ->Bluetooth

Turn on Bluetooth on the phone, search and connect FeiZhiWee 2, after connection is successful, status indicator will stay blue.

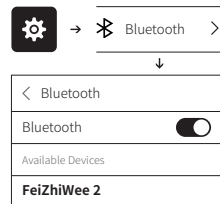

Android Bluetooth connection

For paired controllers, only need to click Logo button when re-connecting next time, not necessary to hold the button

STEP4:Start the game

For better gaming experience, please start game under Flydigi Controller Assistant

For Android devices, it is supported to add games, for games not downloaded from Flydigi Gamepad Assistant, they can be added by the "+" sign in "My Game" and configured in a customized way.

Connection instruction for keyboard-mouse mode

Wee 2 supports keyboard-mouse mode, which can extend keyboard and mouse for playing mobile games. When the controller detects a keyboard or mouse is connected, it automatically switches to keyboard-mouse mode

STEP1: Download Flydigi Gamepad Assistant

See STEP1 in "Connection instruction for controller"

STEP2: Activate Flymapping (only applicable to Android devices)

See STEP2 in "Connection instruction for controller"

STEP3: Connect keyboard and mouse

Connect USB keyboard and mouse to controller as shown in the below figure. After connection is successful, status indicator of controller will stay steadily orange

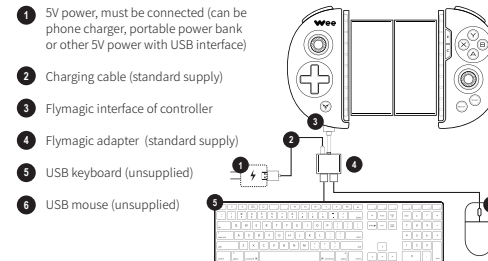

STEP4: Use Bluetooth to connect phone and start the game

See STEP3 in "Connection instruction for controller" and complete Bluetooth connection between controller and phone in Flydigi Controller Assistant. Once Flydigi Controller Assistant is started, it automatically recognizes keyboard and mouse so you may play phone game with them. For gaming operations, please refer to Operation Wizard of Flydigi Controller Assistant

Note: Keyboard-mouse mode supports keyboard and mouse devices with USB interfaces, including USB wired keyboard and mouse, wireless keyboard/mouse suite, wireless mouse

Instructions of basic operations and indicators

Power on/off	Slide the power switch to the right, then controller will be turned on Slide the power switch to the left, then controller will be turned off.	Power indicator will slowly flash green twice before it goes out indicating controller is successfully turned on
Bluetooth pairing	Press and hold Logo button for over 5 seconds after controller is turned on	Status indicator will quickly flash blue indicating controller is entering pairing mode
Normal working	Controller is working normally after Bluetooth connection is successful	Under controller mode: LED indicator stay blue Under keyboard-mouse mode: LED indicator stay orange
Reconnecting with Bluetooth	Use the paired controller again, click Logo button to automatically reconnect with Bluetooth	Status Indicator will be the same as normal working condition after successfully connected
Charging	Charging	Power indicator will stay red
	Charging completed	Power indicator goes out
Low Power	20% power remains	Power indicator slowly flashes green
	10% power remains	Power indicator quickly flashes green
Activating button mapping	Use data cable provided with phone to connect controller's Flymagic interface and Android phone, and slide the power switch to the right again, controller will enter button mapping activation mode	Under activation mode, Power indicator will stay green, LED indicator quickly flashes orange; After activation is successfully, LED indicator will stay orange for 5 seconds before it goes out
Calibrating stick	Press and hold SELECT + START buttons for 2 seconds at the same time	LED indicator will slowly flashes blue twice indicating stick calibration is successful

Performance specifications

Supported platforms	Android	Android phones and tablets with Bluetooth 4.0, while Android system is 4.4 and above	
Supported phone size	Android	6.3" and under, thickness no greater than 8.5mm	
Connection method	Bluetooth 4.0		Distance of use Less than 10m
Battery life	About 80 hours		Battery capacity 300mAh lithium battery
Power consumption	Operational current ≤2.5mA; standby current ≤4uA		Charging input 5V-100mA
Charging time	About 3-4 hours		Controller weight 120g

FAQ

1 What if the controller indicator is not on?

Please check whether controller has sufficient power.

2 What if button mapping cannot be activated?

Please confirm whether operation is correct, please refer to button mapping activation wizard in Flydigi Controller Assistant for details;
Please use original data cable of the phone for activation operation (charging cables without data transmission function cannot complete activation);
Please check whether controller has sufficient power; if power indicator keeps flashing quickly or slowly after power switch is turned on, it indicates that controller does not have sufficient power, therefore it cannot activate button mapping, please charge controller first before trying button mapping activation again.

3 What can keyboard-mouse mode do?

Keyboard-mouse mode is an innovative design of Flydigi controllers that allows you to use controller as keyboard/mouse converter. You can connect keyboard and mouse with USB interface to Wee 2 controller and connect it with terminals such as phones and tablets by Bluetooth, and then control phone games by your keyboard and mouse.

4 How can I use keyboard-mouse mode?

See "Connection instruction for keyboard-mouse mode" for details.

5 Can I use keyboard-mouse mode with controller mode at the same time?

No.

Stretchable Controller + Keyboard/Mouse Converter 2 in 1

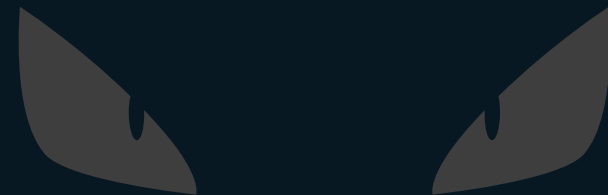

User Manual